

19" DYNAframe OPEN FRAME
System R A C K s



19" DYNAframe OPEN FRAME System R A C K S

W=530mm DYNAframe OPEN FRAME System Racks

DYNAframe series Open Frame System Racks offered for Networking and Servering applications, where there is no need of a closed enclosure due to security, climatized, and dust free conditions like Datacentre, Laboratories, Clean Rooms.

As well if only the cabling work to be completed with passive networking equipments and cabling, than the DYNAframe solutions provide a very cost effective solution, with ergonomy and easy assembly

While product gives maximum performance on servering and networking infrastructure, in parallel provides a very respective economy compared to its quality which is based on high technologic fully automated industry.

The product range is available in 5 heights from 27U through 48U.

The wide product height portfolio meets any U requirement in infrastructure needs.

The product range attracts the attention with the mostly environmentally fit and selected color of RAL 9005 Black, and RAL 7035 Light Grey, with fine wrinkle soft touch paint.

Completely standard and stocked product portfolio, being delivered as Flat Packed product, as shipping configuration the adjustable feet group is included. With flat package, product range is offering a superior result of economic transport cost scheme.

DYNAframe Series product range with optimal panel mounting size, and a variety range of accesories , especially the most functional cable management accesories enclose the whole expectation of users.



CONSTRUCTION DETAILS:

Main Profile- Framework- Top/Bottom Frame:

Automated bending technology applied Frame system, from steel material 2,0mm thickness.

The connection L supports on top are 4,0mm thickness Steel Material



The connection L supports on bottom are 4,0mm thickness Steel Material where the caster group or leveling feet assembled into 12mm diameter holes.



DYNAframe series Open Frame System racks have a professional technical but aesthetic look with the mostly environmentally fit and selected color of RAL 9005 Black, and RAL 7035 Light Grey, with fine wrinkle soft touch paint.

Fully Modular structure, easy assembly and flat pack supply operated with high quantity in shipment vehicles. Easy assembly measured value of 8 minutes for double frame, and 3 minutes for Single Frame can be performed.

Heavy duty structure of frames and L supports results to high load capacity of: 600 kgs.

Two Frame models are available, d80mm and d160mm. Single Frame Model can be created from both d80mm and d160mm frames. Double section segment is created from d80mm frames.

With depth Frame connection brackets, D:670mm, D:870mm, D:1070mm Double Frames can be configured.

All Free Standing Shelving accessories are compatible with the double frame System racks, selection of shelves are as per the depth information mentioned in the accessory section, and compatibility charts.

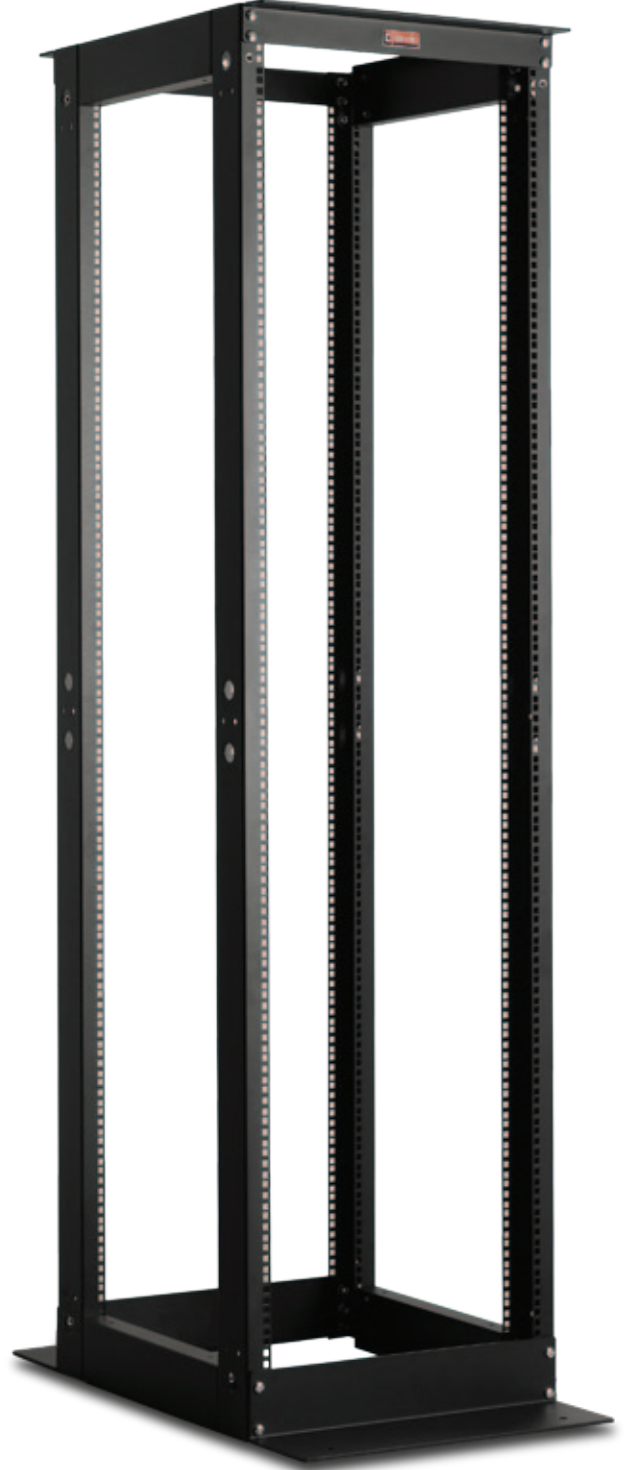

Width=530mm
Depth=670/870/1070mm

Standard Heights:

5 different U heights:
27U, 36U, 42U, 45U, 48U

Standards, and Compliances:



ISO 9001:2008
Quality Management System

EN 61587 -1:2012
Mechanical Structures for
Electronic Equipment

IEC 297-1, 19" mounting
IEC 297-2 Overall cabinet dimensions



CE conform to
EN 60950-1:2006
Information Technology
Equipment – Safety – Part-1-
General Requirements



Environment Friendly;
*Environmental awareness
*RoHS compliancy
*% 100 Recyclable
Material

Load Capacity: 600 kgs.



DYNAframe series OPEN FRAME SYSTEM RACKs networking Frames are with 19" w:530mm and d:670/870/1070 mm base L parts size, physical sizes, 5 different height, gives a wide selection chart for users. The connection part between Frames are changing for maintaining the D:670/870/1070mm depths which are variants of having the same accessories of the standard cabinets

Depth of frame is 80mm, where Base L parts overall depth is D:670/870/1070mm,

Top and Bottom Frame Cases has 19" provision of 3U for 670mm depth, 6U for 870mm depth, 9 U for 1070mm depth configurations where suitable purpose 19" cable management accessories can be positioned for carrying and fixing cables, see case study drawings at later pages.

Standard Color:



RAL 7035 Light Grey



RAL 9005 Black

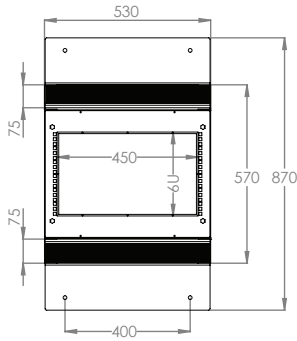

BOTTOM VIEW

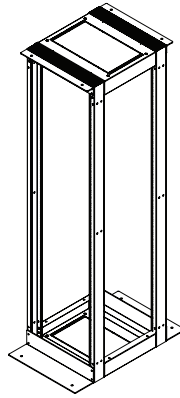

ISOMETRIC VIEW

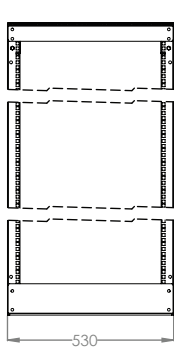

FRONT VIEW

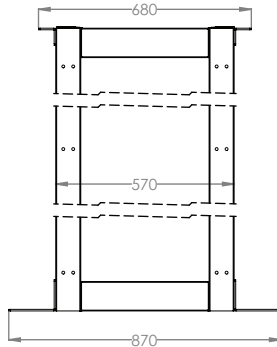

SIDE VIEW

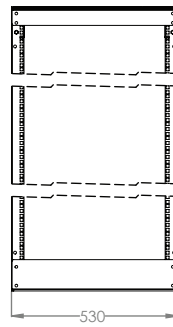

REAR VIEW

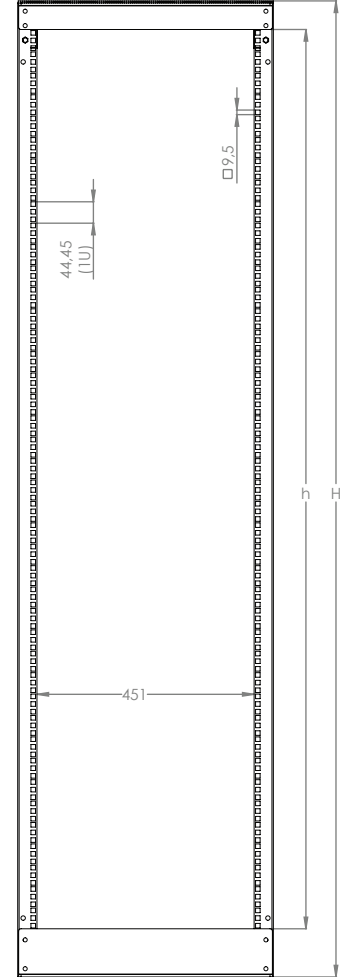

DIMENSIONS
IN
WIDTH AND HEIGHT

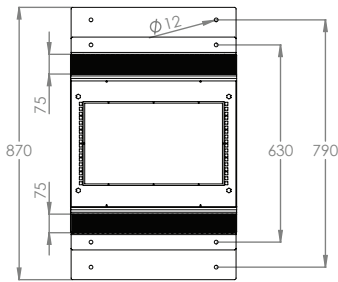

TOP VIEW

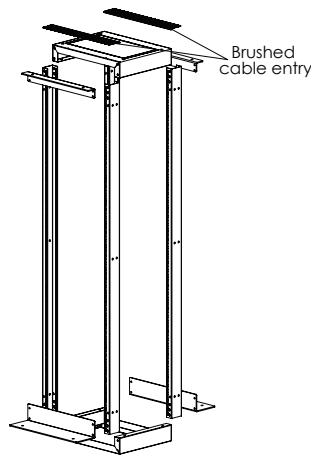

EXPLODED VIEW

19" DYNAframe OPEN FRAME SYSTEM RACKs Double Frames d:80mm Frame Unit Width:530mm Depth: 870mm

ROOT Product Number ***	Product Description	Size WxDXH mm	h size in U	h in mm	H mm, overall without feet and/or castor	Width Overall mm	Width Rail to Rail	Depth Overall mm	Depth Front Rail to Rear Rail mm	PACKING DIMENSIONS of PACK 1 WxDXH mm	PACKING DIMENSIONS of PACK 2 WxDXH mm	QTY IN PACKAGE	Standard NET Weight of product kgs	Gross Weight of Product kgs
LN-OF27UDD870-CC	27U D=80mm Frame Double Frame Open System Rack D=870mm	530x870x1356	27U	1200	1356	530	19"	870	570	165x150x1375	550x550x120	1	34,2	35,2
LN-OF36UDD870-CC	36U D=80mm Frame Double Frame Open System Rack D=870mm	530x870x1756	36U	1600	1756	530	19"	870	570	165x150x1775	550x550x120	1	38,4	40
LN-OF42UDD870-CC	42U D=80mm Frame Double Frame Open System Rack D=870mm	530x870x2022	42U	1867	2022	530	19"	870	570	165x150x2040	550x550x120	1	41	43
LN-OF45UDD870-CC	45U D=80mm Frame Double Frame Open System Rack D=870mm	530x870x2156	45U	2000	2155	530	19"	870	570	165x150x2175	550x550x120	1	42,3	44,5
LN-OF48UDD870-CC	48U D=80mm Frame Double Frame Open System Rack D=870mm	530x870x2289	48U	2133	2289	530	19"	870	570	165x150x2310	550x550x120	1	43,5	46

***CC= LG for Light Grey RAL 7035 & BL for Black RAL 9005 for customers to define while ordering.